

brand	<b>MEP</b>
-------	------------

date	JAN/02	SHEET 1/3
------	--------	-----------

Model

<b>MP - ER 650SP</b>

Product number

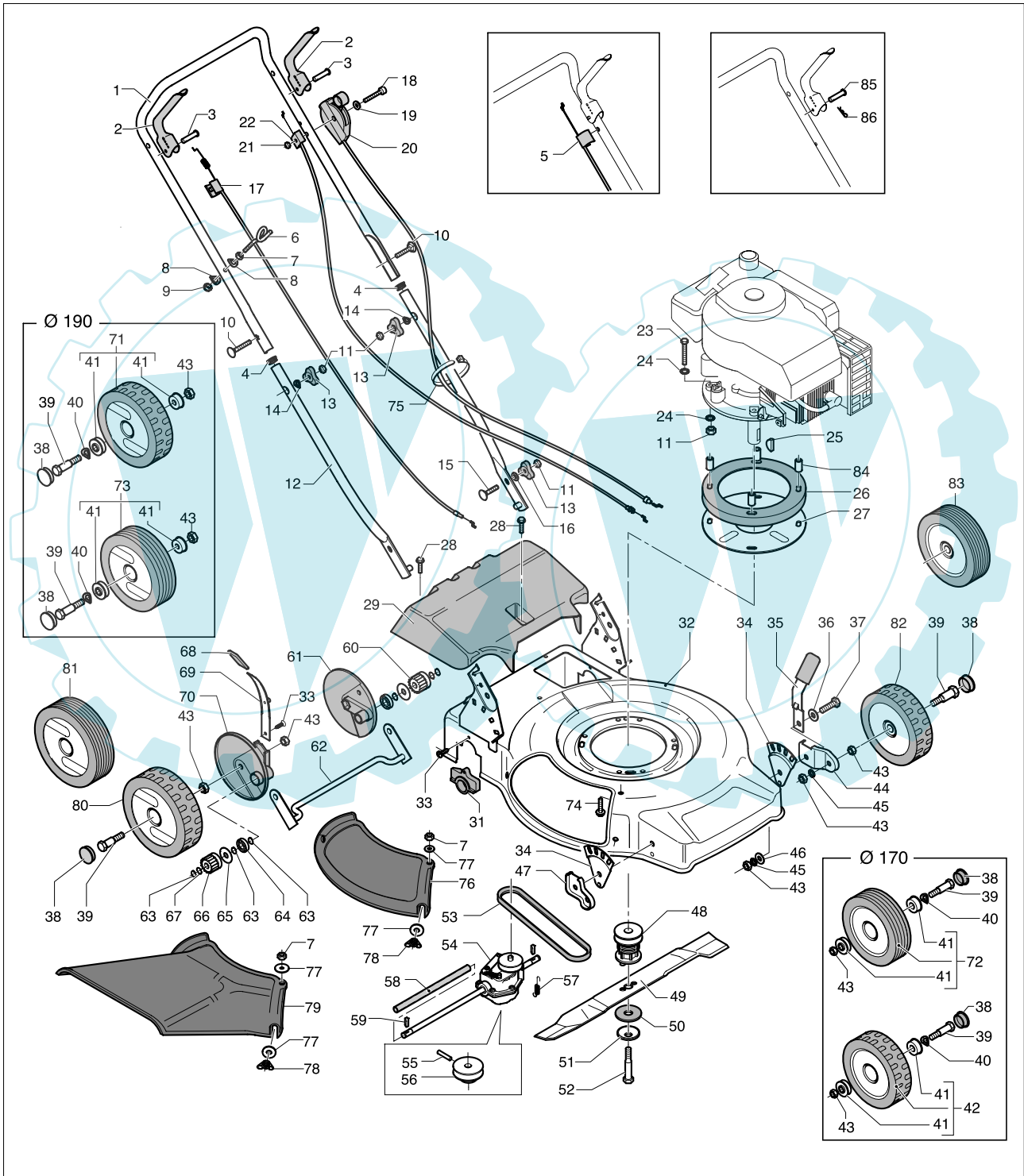
**The Electrolux Group. The world's No.1 choice.**

brand	<b>MEP</b>
-------	------------

date	JAN/02	SHEET 2/3
------	--------	-----------

<b>MP - ER 650SP</b>
----------------------

Pos.	PN ELX	PN MEP	DESCRIZIONE	DESCRIPTION	DESCRIPTION	Q.ty	NOTE
1	531206029	10146653	manico superiore	upper handle	guidon superieur	1	
2	531206027	10146633	maniglia freno	lever	manette	2	
3	531206032	10146713	perno	pin	pivot	2	
4	531208950	20833303	tappo	plug	bouchon	2	
5	531206025	10146610	cavo freno	cable	cable	1	TECNA
5	531206026	10146620	cavo freno	cable	cable	1	B&S
6	531205169	10121470	gancio	cable hook	crochet	1	
7	531207165	10501200	dado	nut	ecrou	2	M6 H6 UNI 5587-6S-ZB
8	531204961	10115900	rondella ondulata	washer	rondelle	2	6,5E
9	531208491	20281800	dado	nut	ecrou	1	M6 H8 UNI7473- ZB
10	531207089	10402401	vite	screw	vis	2	TTSQ M8x50 TF ZB
11	531207982	20106300	dado	nut	ecrou	7	M8 H8 UNI 5587-6S ZB
12	531206071	10150133	manico inferiore	handle lowere	guidon inferieur	2	
13	531204923	10114303	pomolo	knob	poignée	4	
14	531207090	10402402	rondella ondulata	washer	rondelle	2	8,5
15	531204921	10114100	vite	screw	vis	2	TTSQ M8x25 T.FIL. ZB
16	531204922	10114200	rondella piana	washer	rondelle	2	8x16x1,5 ZB
17	531206024	10146600	cavo frizione	clutch cable	cable d'embrayage	1	
18	531206212	10155420	vite	screw	vis	1	TE M5x60 UNI 5739-4.8 T.F
19	531206666	10284700	rondella piana	washer	rondelle	1	5/15/1,5 ZB
20	531206210	10155360	acceleratore	accelerador	accélérateur	1	B&S 1430/48
20	531206030	10146670	acceleratore	accelerador	accélérateur	1	TECNA-HONDA mm. 1070/48
21	531205213	10121890	dado	nut	ecrou	1	M5 DIN 6923
22	531205191	10121610	cavo freno	cable	cable	1	B&S
22	531205192	10121620	cavo freno	cable	cable	1	TECNA 1420/141,5
22	531205813	10140950	cavo freno	cable	cable	1	HONDA
23	531207107	10407800	vite	screw	vis	3	TE M8x65 UNI 5737-8,8-ZB
24	531207981	20106200	rondella dent.	washer	rondelle	6	D.8E DIN 6798
25	531204907	10100900	chiavetta	key	clavette	1	4x6,5 UNI6606 WODRUF
26	531207369	10600503	anello distanziatore	ring	anneau	1	
27	531207111	10425703	carter	housing	carter	1	
28	531207120	10427400	vite	screw	vis	3	TE FRTC 4,8x13
29	531206227	10158253	carter di protezione	protection guard	carter de protection	1	
31	531205944	10146093	supporto	bearing	support	2	
32	531211031	10177601	scocca	deck	chassis	1	MP
32	531211032	10177602	scocca	deck	chassis	1	ER
33	531208216	20135720	vite	screw	vis	3	TCTC2FD5x16 AC
34	531205925	10146010	supporto	bearing	support	2	
35	531204913	10107203	leva alzaruote	lever	levier	2	
36	531206020	10146530	rosetta	washer	rondelle	2	UNI 8840 B12 (13/24/1)
37	531204912	10107100	vite	screw	vis	2	
38	531204936	10114804	tappo ruota	plug	bouchon	4	
39	531205042	10120090	vite	screw	vis	4	
40	531206644	10275100	rondella dent.	washer	rondelle	4	UNI 8840- B12(13/24/0,8



brand	<b>MEP</b>
-------	------------

date	JAN/02	SHEET 3/3
------	--------	-----------

<b>MP - ER 650SP</b>
----------------------

Pos.	PN ELX	PN MEP	DESCRIZIONE	DESCRIPTION	DESCRIPTION	Q.ty	NOTE
41	<b>531205214</b>	<b>10121900</b>	cuscinetto	ball-bearing	roulement	8	
42	<b>531205214</b>	<b>09120084</b>	ruota anteriore	front wheel	roue anterieur	2	D170/26 TAC-MP
43	<b>531207978</b>	<b>20101700</b>	dado	nut	ecrou	10	M10 H8 UNI 5588-6S ZB
44	<b>531204915</b>	<b>10107302</b>	supporto ruota	wheel bearing	support de roues	1	DX
45	<b>531208974</b>	<b>30102100</b>	rondella dent.	washer	rondelle	4	10E
46	<b>531207989</b>	<b>20113000</b>	rondella piana	washer	rondelle	2	10x30x2,5
47	<b>531204914</b>	<b>10107301</b>	supporto ruota	wheel bearing	support de roues	1	SX
48	<b>531207848</b>	<b>10831300</b>	supporto lama	bearing blade	support lame	1	
49	<b>531206546</b>	<b>10177510</b>	lama	blade	lame	1	D.502MM
50	<b>531207243</b>	<b>10531700</b>	rondella frizione	washer	rondelle	1	17,2x50x1,5+0,1
51	<b>531207237</b>	<b>10530900</b>	rondella elastica	washer	rondelle	1	11x50x2,5
52	<b>531206649</b>	<b>10280901</b>	vite lama	screw	vis	1	TE D.3/8" UNFX65(8.8)
53	<b>531206303</b>	<b>10160220</b>	cinghia	belt	courroie	1	Z.29-L 730
54	<b>531204761</b>	<b>09768700</b>	riduttore	reducer	reducteur	1	
55	<b>531207703</b>	<b>10768400</b>	spina elastica	resilient pin	goupille expansible	1	
56	<b>531208899</b>	<b>20768203</b>	puleggia riduttore	gear pulley	poulie reducteur	1	
57	<b>531206235</b>	<b>10158320</b>	molla	spring	ressort	1	
58	<b>531207697</b>	<b>10766503</b>	tubetto distanziale	spacer tube	toyau entretoise	1	
59	<b>531205108</b>	<b>10121160</b>	chiavetta	key	clavette	2	"S" 5x5(- 0,05)x19,2 DIAG DX
60	<b>531205046</b>	<b>10120170</b>	pignone	pinion	pignon	1	
61	<b>531205195</b>	<b>10121673</b>	flangia	flange	bride	1	
62	<b>531206233</b>	<b>10158300</b>	assale	axle	assieu	1	
63	<b>531208772</b>	<b>20655800</b>	seeger	seeger	seeger	6	D.12E DIN 471
64	<b>531208778</b>	<b>20657600</b>	cuscinetto	ball-bearing	roulement	2	D.12/28/8 6001/2RS
65	<b>531207847</b>	<b>10831200</b>	rondella piana	washer	rondelle	2	D.12/34/0,7 ZB
66	<b>531205045</b>	<b>10120160</b>	pignone	pinion	pignon	1	SX
67	<b>531208859</b>	<b>20761300</b>	rondella temp.	washer	rondelle	2	D.12,4x17x0,3
68	<b>531207986</b>	<b>20107203</b>	guaina	sheating	gaine	1	
69	<b>531205228</b>	<b>10121970</b>	leva alzaruote	lever	levier	1	
70	<b>531205194</b>	<b>10121663</b>	flangia assale	flange	bride	1	
71	<b>531204367</b>	<b>09120064</b>	ruota posteriore	posterior wheel	roue posterieur	2	MP-D190/13-TAC
72	<b>531204395</b>	<b>09121574</b>	ruota anteriore	front wheel	roue anterieur	2	ER-D170/26 RIG
73	<b>531204391</b>	<b>09121554</b>	ruota posteriore	posterior wheel	roue posterieur	2	ER-D190/13
74	<b>531208053</b>	<b>20122600</b>	vite	screw	vis	3	M6x20 TE FL
75	<b>531205581</b>	<b>10135600</b>	fascetta	clamp	colier	2	160X4,5
76	<b>531206237</b>	<b>10158353</b>	coperchio	cover	couvercle	1	
77	<b>531205377</b>	<b>10126000</b>	rondella piana	washer	rondelle	3	6x18x1,5
78	<b>531206263</b>	<b>10158520</b>	dado a galletto	wing nut	ecrou a papillon	2	D.M6
79	<b>531206238</b>	<b>10158363</b>	paratoia laterale	deflector	deflecteur	1	
80	<b>531205021</b>	<b>10120054</b>	ruota	wheel	roue	2	MP-D190/13-TAC
81	<b>531205181</b>	<b>10121564</b>	ruota posteriore	posterior wheel	roue posterieur	2	ER-D190/13
82	<b>531205031</b>	<b>10120074</b>	ruota	wheel	roue	2	MP-D170/13-TAC
83	<b>531205189</b>	<b>10121584</b>	ruota	wheel	roue	2	ER-D170/13-RIG
84	<b>531208732</b>	<b>20603300</b>	bussola	bush	douille	3	D13/10/32
85	<b>531207409</b>	<b>10651400</b>	perno	pin	pivot	2	
86	<b>531207408</b>	<b>10651300</b>	copiglia	cotter pin	goupille	2	1.1x17

